

Jeep 6" Conversion Set Part # 10913

Step 1: Prior to Installation:

(A) Verify Fit:

1. Hold the flares onto the vehicle to verify fit.
 - (a) Vehicle moldings and/or other body accessories may need to be trimmed or removed for proper fit of flares.
 - (b) Some filing, sanding, or cutting of flare edge may be necessary to ensure proper fit.

Step 2: Painting: (optional)

- (A) Painting must be done prior to final installing flares on the vehicle
- (B) Clean outer surface of flare with a good grade degreaser.
 1. **DO NOT USE LACQUER THINNER OR ENAMEL REDUCER AS A DEGREASER.**
 2. Wipe outer surface thoroughly with a tack rag prior to paint.
- (C) Paint flares using a high quality enamel, or polyurethane automotive paint. (Application of a primer coat is optional)
- (D) If painting edge trim (not recommended) use a flex additive.

Step 3: Performance:

- (A) Using larger Tires may increase the area required to turn the vehicle. Some Tire/Rim combinations may require lowering bump stops and or installing steering stops to prevent tire from contacting flare.

Step 4: Exhaust System: Modifications may be necessary to maintain a minimum 4" clearance between flares and exhaust pipes. (Exhaust gases should not vent directly onto flares)



TOOLS FOR EASY INSTALLATION

- Utility Knife
- Drill
- Drive bit extension
- #2 Phillips Drive bit/Screw Driver
- Socket Wrench
- 8mm socket
- 8mm wrench
- Automotive trim pry tool
- 1/4" Drill Bit
- Drill Motor

FLARE INSTALLATION PROCEDURES

Step 5: Preparing the Work Area (Front and Rear)

- (A) Remove the marker light from the factory front fender flares.
- (B) Remove the rear wheel well liner using an automotive trim pry tool (a pry bar or claw hammer can work) to release the Christmas tree fasteners. Save for re-installation.
- (C) Remove the factory fender flares and stone guards using an 8mm socket and 8mm wrench.

Step 6: Edge Trim Installation (See Illustration #1)

- (A) Peel two to three inches of red vinyl backing away from edge trim tape and affix to outer edge of flare at one end. **(With Adhesive Strip Edge to the inside of flare)**
- (B) Press edge trim into place along edge of flare in one-foot increments, pulling red vinyl backing free as you continue to work your way around the flare.

Illustration #1

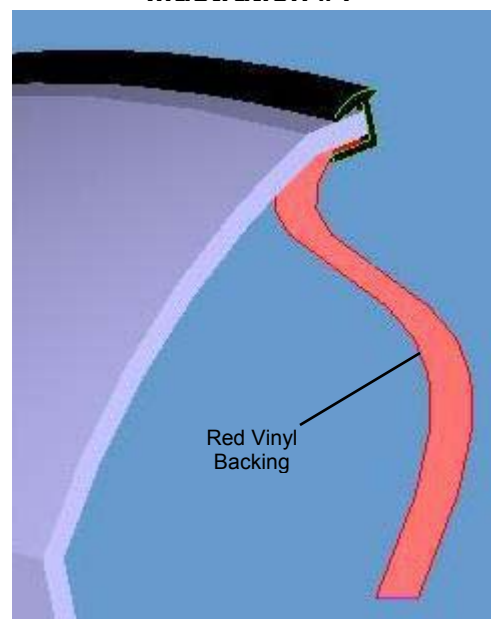

Step 7: Flare and Stone Guard Installation

- (A) Install the marker lights from the factory front flares into the marker light area formed in the Bushwacker front flares.
- (B) Place a supplied washer on each Torx head screw in the hardware kit.
- (C) Place a Torx head screw / washer through the hole in one of the pockets in the flare.
- (D) Slide a 3/8" thick rubber spacer onto the screw from the back side of the pocket until snug.
- (E) Repeat steps 7:(B&C) for the remaining pockets in the flares.
- (F) Holding the flare into position on the fender, insert the screws through the factory holes in the fender.
- (G) To hold the flare in place on the fender, start a supplied nut onto one of the screws in the top area of the flare and leave loose.
- (H) Gently start the screws that correspond with the factory threaded inserts and leave screws loose.
- (I) Start a supplied nut onto the rest of the screws.
- (J) Tighten all the screws using a drive bit extension, the supplied T-30 Torx bit and an 8mm wrench.
- (K) Fasten the stone guard to the vehicle with the factory screws that were previously removed.

Step 8: Front Bumper Piece Installation

- (A) Using the supplied T-30 Torx Bit remove the factory bumper end caps.
- (B) Holding the bumper piece in position on the bumper, place a Torx head screw / washer through each of the holes in the front of the bumper piece.
- (C) Start a supplied nut on the screws and tighten partially with the supplied T-30 Torx bit and an 8mm wrench.
- (D) Line up the bumper piece and flare at the wheel well. (See Illustration #3 and 4).
- (E) (There is a hole in the bumper piece and not in the flare). With a pencil or marker, mark the flare through the hole in the bumper piece. (See illustration #4).
- (F) Pull bumper piece wheel well area out of way before drilling marked hole in flare with 1/4" bit.
- (G) Drill hole.
- (H) Slide a supplied clip onto the fender flare under the marker light aligning it with the hole in the flare just drilled in step "G".
- (I) Fasten the bumper piece to the flare with a supplied #2 Phillips screw.

Illustration #2

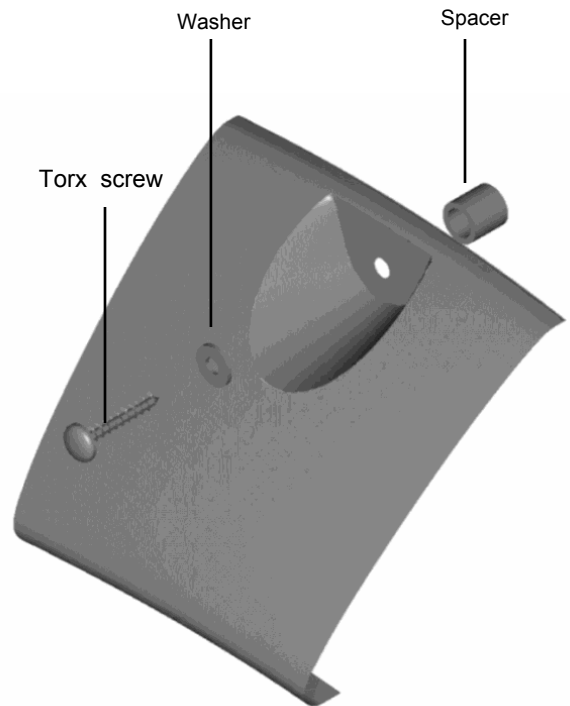

Illustration #3

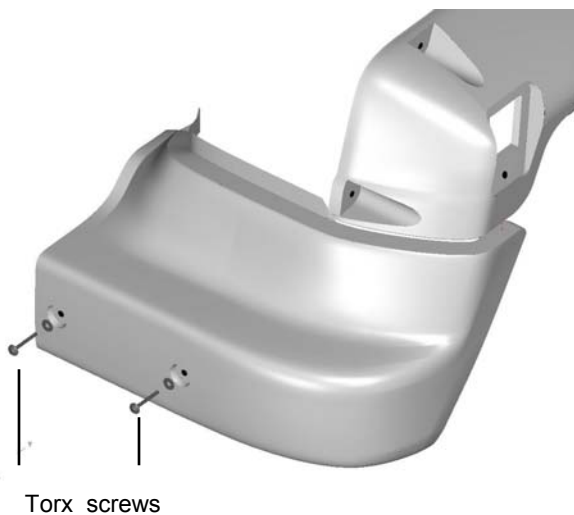

Illustration #4

